

Chubb

3G110 & 3G135 Mortice Deadlocks Fitting Instructions

Before commencing, please read thoroughly to familiarise yourself with these instructions and use of the template. Unless otherwise stated all illustrations show door hung right, viewed from inside and opening inwards. The lock however is suitable for inward or outward opening doors, hinged left or right.

1a. Lock fitting.

Mark height line lightly on the frame, door face and edge 146mm (5 $\frac{3}{4}$ ") above the desired keyhole position also marking a centre line down the door edge. Carefully cut the template from the fitting instructions along the bold dotted line.

1b. Place the mortice lock template on the door edge with the arrows aligned with the centre line and the top of the template level with the height line. The template can be taped temporarily in position to prevent movement. Mark the centres of the holes to be drilled for the lock body with a bradawl.

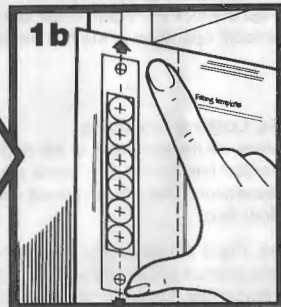
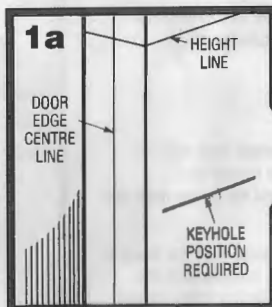

2a. Before drilling holes mark the required depth on the drill bit with adhesive tape. Drill holes for mortice lock with a 19mm (3/4") bit, 3mm (1/8") deeper than the lock to be fitted. Please take great care to keep the drill level and straight, we recommend the use of a brace and bit for drilling holes for lock and locking box mortice.

2b. Carefully remove the remaining wood from the mortice using a 19mm (3/4") chisel so that the lock body fits snugly without excessive force.

N.B. On no account should the lock be hammered into place. When testing the fit it is a good idea to do so with the bolt in a locked position. By holding the bolt the lock can more easily be removed from the mortice.

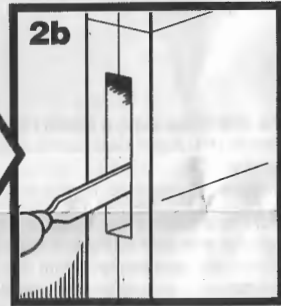
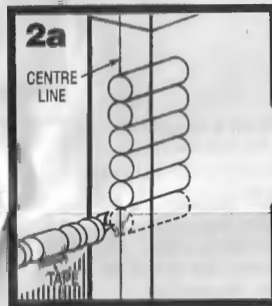

3a. Insert the lock into the prepared mortice then ensuring it is parallel with the door edge mark around the forend.

3b. Remove the lock and carefully chisel out a recess to enable the faceplate to lie flush with the door edge. *N.B. It may be necessary to countersink the faceplate and fixing screw holes.*

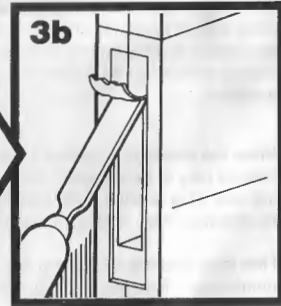

4a. Fold the template along the vertical dotted line and place around the door edge with the top level with the height line. Mark the hole centres with a bradawl.

4b. Drill out holes for keyhole using an 8mm (5/16") and a 5mm (3/16") drill bit as shown on the template. Drill through the door until the point of the drill breaks through on the opposite side. Working from the opposite side complete drilling and open out to form keyhole shape. Using a small round file form keyhole to allow easy entry of key.

Please ensure the drill is level and straight and take care when the drill breaks through the wood on the opposite side to reduce splintering.

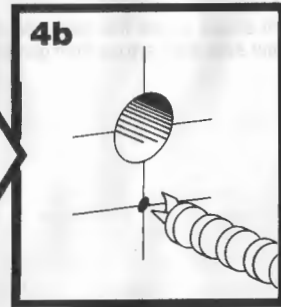
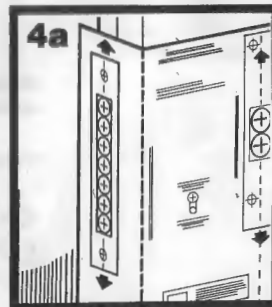

5a. Remove faceplate. Fit the lock into the prepared mortice and mark fixing holes with a bradawl. Secure with the 11/4" x 8 screws provided using a no. 2 pozidrive screwdriver. Replace faceplate.

5b. Place the keyplate over the keyhole then insert the key, ensure the key is central in the keyplate then mark the screw holes with a bradawl. Remove the key and fix to the door with the 1/2" x 4 slotted head screws using a suitably sized screwdriver.

Test the lock from both sides with the key to ensure smooth operation of the bolt before proceeding.

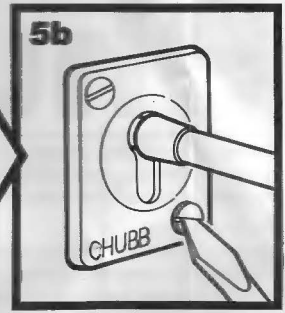
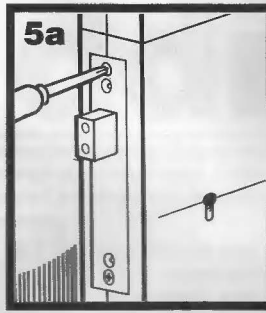

5a. Locking box fitting.

Measure the thickness of the door edge and mark a vertical line on the door frame equal to half this dimension. This measurement should be taken from the door stop.

5b. Place the locking box template level with the height line marked previously and align the arrows with the vertical line. Mark the centres of the holes to be drilled for the locking box with a bradawl.

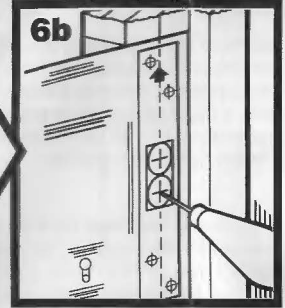

7a. Drill holes using a 22mm (7/8") drill bit to a depth of 25mm (1"). Again take care to keep the drill level and straight. Chisel out the wood for the locking box and box flanges (if applicable) to give a snug fit.

7b. Place locking box in position making sure it is parallel with door frame and mark around its edge. Clearance between faceplate and locking box should be adequate to ensure smooth operation. Recess into frame if required. Fit locking box and mark the position of the fixing screw holes with a bradawl and secure in place using a no. 2 pozidrive screwdriver. It may be necessary to countersink screw holes for correct seating of locking box. Close the door and test the operation.

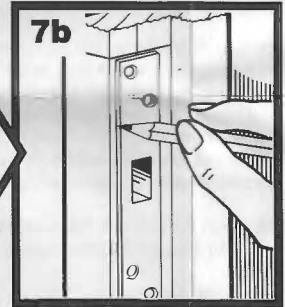
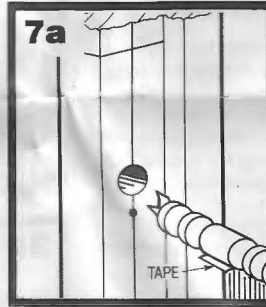

When the deadbolt is locked it is quite normal for minimal play to be apparent between the locking box and bolt. This is not a defect but is necessary to prevent the deadbolt from binding, causing premature wear.

If the lock requires lubricating use only a proprietary maintenance fluid (e.g. WD40) not oil.

Additional Keys

To ensure trouble free operation of lock, please request that extra keys are cut from genuine Chubb key blanks.

All dimensions given on instruction sheet and template are approximate.

Printed in England

Chubb Locks Limited
P.O. Box 197, Wednesfield Road,
Wolverhampton WV10 0ET

Centre line of door.

Drill 6 holes 19mm (3/4") dia. for mortice lock.

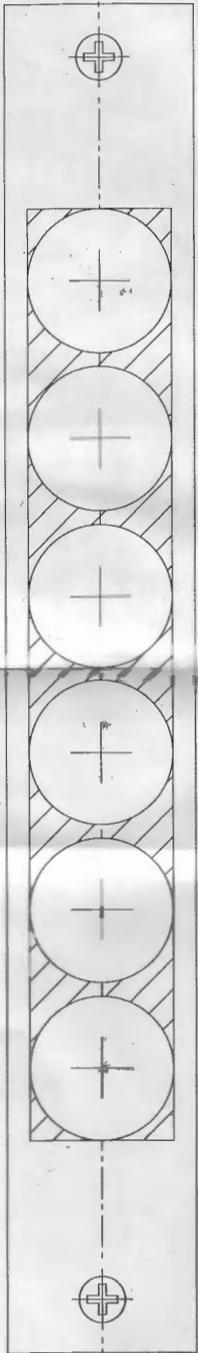

Fold dotted line along door edge to mark position of keyhole.

Carefully cut along line and place edge on height line.

Fitting Template for 3G110 & 3G135

Due to working tolerances in both printing and manufacture minimal variation may exist between template and product. Please check before proceeding.

Drill 8mm (5/16") dia. hole.

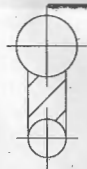

Drill 5mm (3/16") dia. hole.

Drill 2 holes 22mm (7/8") dia. for locking box.

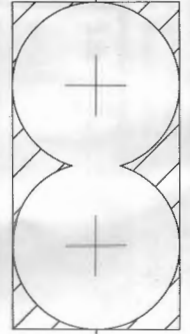

 Remove shaded area to form mortice to suit lock body, locking box, and keyhole.



Comprehensive fitting instructions with template

All fixing screws supplied

Tools required:

- Drill with 5mm ($\frac{3}{16}$ "), 8mm ($\frac{5}{16}$ "), 19mm ($\frac{3}{4}$ ") and 22mm ($\frac{7}{8}$ ") dia. bits.
- Bradawl
- Chisel 19mm
- Mallet
- No. 2 pozidrive screwdriver
- Small flat screwdriver
- Round file 5mm ($\frac{3}{16}$ ") dia.
- Pencil
- Rule
- Scissors

S440/151